

TRANSFORM YOUR DECOR

FUN & EASY PAINTING PROJECTS
FOR YOUR HOME



Featuring
3 new
hand-selected
FolkArt color
palettes

9 TREND INSPIRED DIY PROJECTS

INTRODUCTION

The trusted quality of FolkArt Acrylics makes this the premium acrylic paint for any craft, DIY, or art project. FolkArt Acrylics, known for their artist-grade pigments, provide excellent blendability and superior coverage. And it's the perfect brand of paint for stenciling, stroke work and detail painting.

Be inspired! FolkArt has created three new color trend collections: Cottage Chic, Coastal and Romantic.

COTTAGE CHIC

If being surrounded in a cozy, casual cottage environment is your ideal setting, then let the FolkArt Cottage Chic color palette be your inspirational guide. Create home decor projects using a vintage color grouping of delicate, cool white, tea rose, shades of wisteria, and buttercup yellow.



COASTAL

Bringing that wonderful feeling of relaxation home from the beach is the inspiration behind the FolkArt Coastal color palette. Making a statement with seafoam greens, oceanside blues, and colors of seashells combined with marine life motifs will definitely create a casual, beach chic feel.



ROMANTIC

Romance is definitely in the air when painting with colors from the FolkArt Romantic color palette. The combination of colors evoke a country garden, while French inspired stencils and hand painted accents bring casual sophistication into the spotlight.



Whether creating a small trend nook in your home or decorating an entire room, these inspirational color trend projects will teach you step-by-step how to recreate home decor following the trend of your choice.

TABLE OF CONTENTS

- MISCELLANEOUS SUPPLIES 3
- SURFACE PREPARATION 3
- STENCILING BASICS 4
- FOLKART ACRYLIC COTTAGE CHIC COLOR TREND COLLECTION
 - Color Chart and Color Trend Inspiration 5
 - Cottage Chic Floral Canvas..... 6
 - Trio of Cottage Chic Birdhouses 7
 - Believe Cottage Chic Sign..... 8
- FOLKART ACRYLIC COASTAL COLOR TREND COLLECTION
 - Color Chart and Color Trend Inspiration 9
 - Coastal Beach Sign.....10
 - Coastal Storage Crates, Starfish Frame & Serving Tray 11
 - Coastal Star Stenciled Lampshade & Buoys ..12
- FOLKART ACRYLIC ROMANTIC COLOR TREND COLLECTION
 - Color Chart and Color Trend Inspiration13
 - Romantic Hand Painted Candlesticks.....14
 - Romantic French Tapestry15
 - Romance-Inspired Hand Painted Boxes .. 16-17
- ABOUT THE DESIGNERS.....18
- CREATIVE CREDITS18

STENCILING BASICS

HOW TO PROPERLY LOAD A STENCIL BRUSH

When stenciling, a “Dry Brush Method” is recommended. Slightly dip the flat bristles into a small puddle of paint, so that the surface of the bristles is wet, yet not completely saturated. Next, off load the brush onto a paper towel using a circular motion. Continue to wipe the brush, moving to a clean spot on the paper towel until you have a “dry brush” with very little paint. It is important to remove most of the paint. Using too much paint, when stenciling, may cause paint to bleed under the stencil creating an unwanted mistake.

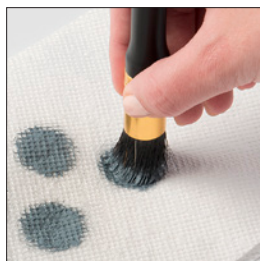

HOW TO SECURE A STENCIL IN PLACE

It is important to secure a stencil in place to prevent any movement of the design. Stencils can be secured to a project surface using stencil or painter’s tape. It is best to tape along all four stencil edges. To protect the project surface, additional tape can be placed in areas where a cut stencil design is close to the stencil edge.



HOW TO MASK A STENCIL

If a stencil is closely filled with many design elements, and only a few design elements are to be stenciled, or if a variety of colors will be used in close proximity to each other, the best technique is to mask over portions of the stencil, using either tape, a piece of paper or stencil blank.



HOW TO STENCIL

There are two basic stenciling techniques used by most stencilers: “The Circular Motion” and “The Dabbing or Stippling Motion.” Experiment and decide which technique is best for you.

- **The Circular Motion** – This technique is used most often by stencil professionals wanting to achieve even color application. Beginning at the edge on the uncut portion of the stencil, hold the loaded stencil brush upright, touch the surface and begin moving the brush in a circular clockwise/counterclockwise motion. Then, slowly move the brush over the cut openings of the stencil. Continue stenciling, working from the outside of the design inwards toward the center. It is best to stencil with a light touch as the color can be intensified with additional layers.
- **The Dabbing or Stippling Motion** – This technique is most often used by general crafters. Working with the brush upright to the project surface, begin tapping the surface up and down over the entire cut areas of the stencil design. Continue dabbing, or stippling, over the open areas until the entire stenciled design is complete.

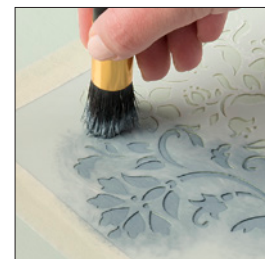

HOW TO PROPERLY CLEAN A STENCIL

It is important to clean a stencil after each use to keep the design edges clean and crisp. A well-used and dirty stencil (with acrylic paint build up) will not provide clean detailed lines. Immediately, after each use, simply wipe a stencil with a baby wipe or rinse it well under running water. For tough, dried acrylic paint left on a stencil, cleaning with rubbing alcohol or hand sanitizer may rescue the stencil. A mylar stencil can even be soaked overnight in rubbing alcohol, however, any printed registration marks may also be “cleaned” away.

TRANSFORM YOUR DECOR

COTTAGE CHIC COLLECTION

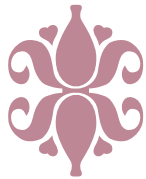

6451
Vintage Tea Rose



6453
Prairie Sunset

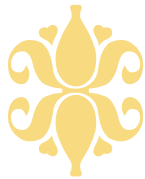

6448
Daybreak



6456
Mossy Meadow



6457
Wisteria



6462
Iced Coffee



6446
Cottage White

The Cottage Chic Color Trend is a cozy, casual decorating style that embraces both comfortable and eclectic treasures. It features a refreshed, yet vintage color palette.

This new trend color palette of tinted hues encompasses taupe, peach, an earthy green, a soft delicate, cool white, wisteria blue, vintage rose, and buttercup yellow. This color palette is complemented with natural elements of pine, wicker, and terra cotta.

The charm of Cottage Chic is also enhanced with distressed finishes which further embrace the vintage look and feel of days long gone.

Within this trend, decorative motifs are diverse and projects can easily be personalized with the use of typography add that personal touch with a favorite word, phrase or name.



COTTAGE CHIC FLORAL CANVAS

By Kirsten Jones

The use of country florals, stenciled and then distressed offers a fresh, casual twist on stenciling. This canvas, fashioned with the soft, vintage FolkArt Acrylic Cottage Chic Color Trend Collection, incorporates buttercream yellow, the color of vintage roses, mossy greens, and a soft taupe all accented with a splash of deep burgundy. It is a work of art that is beautiful and calming.

INSTRUCTIONS

Refer to Stenciling Basics on page 4 for helpful how-to stenciling hints.

1. Prepare the canvas panel by base coating Cottage White. Allow to dry. If desired, apply a second application for opaque coverage.



2. Using the Garden large floral stencil, a 5/8" stencil brush and stencil tape, stencil an overall floral pattern on the 11" x 14" canvas. Refer to the project photo for design placement and color suggestions.
 - Pink Blossoms - Daybreak, Prairie Sunset and Vintage Tea Rose
 - Burgundy Blossom - Daybreak, Vintage Tea Rose and Berry Wine**(Photo A & B)**
 - Leaves - Mossy Meadow
 - Butterfly - Daybreak and Prairie Sunset

NOTE: It is best to allow one stenciled floral blossom to completely dry before stenciling a second blossom nearby.
3. When completely dry, lightly sand the entire canvas using medium grit sandpaper to create a soft, distressed effect, adding texture to the stenciled design. **(Photo C)**
4. Basecoat the frame Cottage White and let dry.
5. Next, paint over the frame with Iced Coffee. Allow to dry.
6. Sand to distress both the interior and exterior edges of the frame exposing some of the Cottage White base layer.

Supply List

FolkArt® Acrylic Colors -
Cottage Chic Collection
Cottage White, Daybreak,
Vintage Tea Rose, Prairie
Sunset, Mossy Meadow,
Iced Coffee

FolkArt Acrylic Colors -
Berry Wine

FolkArt Mylar Variety Pack
Stencil - Garden

FolkArt 5/8" Stencil Brush

Studio Décor® Frame -
11" x 14" Belmont

Artist's Loft® Necessities™
Canvas Panel - 11" x 14"

Miscellaneous supplies found
on page 3

TRIO OF COTTAGE CHIC BIRDHOUSES

By Kirsten Jones

This trio of painted and stenciled birdhouses offer the look and feel of warm, cottage inspired florals. This Cottage Chic color selection is simple, yet provides a comfortable vintage appeal. Whether creating one, three, or several birdhouses, the coordinated color combinations, from this collection, are endless!

INSTRUCTIONS

Refer to Stenciling Basics on page 4 for helpful how-to stenciling hints.

1. Using a 3/4" flat brush, basecoat each birdhouse Wicker White and let dry.
2. Using medium grit sandpaper, lightly sand the base coated surface smooth before applying a second color. Wipe each surface with a damp paper towel to remove sanding dust.

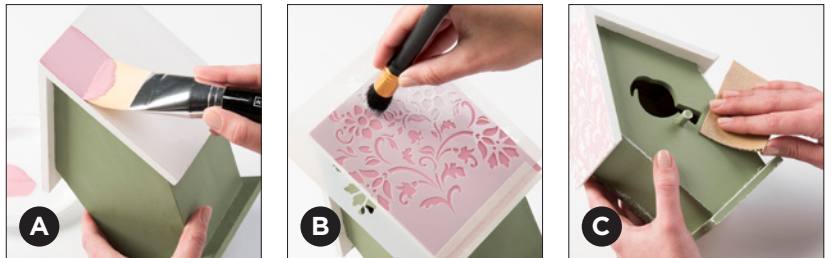

3. **Birdhouse No. 1** – Basecoat Mossy Meadow on the body of the house and Vintage Tea Rose on the roof. Let dry. **(Photo A)**
4. **Birdhouse No. 2** – Basecoat a second coat of Wicker White on the body of the house. Paint the roof Berry Wine. Allow to dry.
5. **Birdhouse No. 3** – Basecoat Daybreak on the body of the house and Prairie Sunset on the roof. Allow to dry.
6. Using the Lovely Floral painting stencil, a 5/8" stencil brush, stencil tape, and Wicker White, stencil the overall floral pattern on each section of roof. **(Photo B)**
7. When each birdhouse is thoroughly dry, create a warm, distressed effect by lightly sanding the birdhouse edges using medium grit sandpaper. **(Photo C)**

Supply List

FolkArt® Acrylic Colors -
Cottage Chic Collection
Daybreak, Vintage Tea Rose,
Prairie Sunset, Mossy Meadow

FolkArt Acrylic Colors -
Wicker White, Berry Wine

FolkArt 6" x 6" Small Painting
Stencil - Lovely Floral

FolkArt 5/8" Stencil Brush

ArtMinds® Birdhouse with bird
silhouette - quantity 3

Miscellaneous supplies found
on page 3

BELIEVE COTTAGE CHIC SIGN

By Kirsten Jones

Create an on-trend personalized painted sign in just a couple hours! Selecting a neutral color from the FolkArt Acrylic Cottage Chic Color Trend Collection allows this project the versatility of placement in any room of the home.

INSTRUCTIONS

Refer to Stenciling Basics on page 4 for helpful how-to stenciling hints.

1. Apply a basecoat of Wicker White to the entire frame/ plaque using a basecoating brush. Allow to dry thoroughly.
2. Lightly sand to smooth the surface. Reapply a second base of Wicker White to the interior of the frame.
3. Paint the exterior raised portion of the frame Iced Coffee and allow to dry.

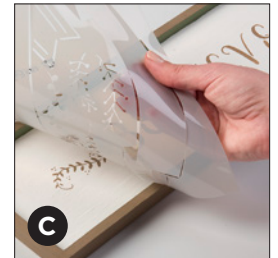
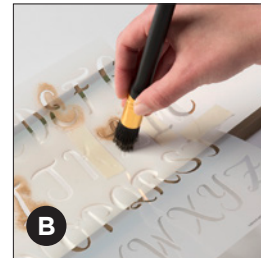
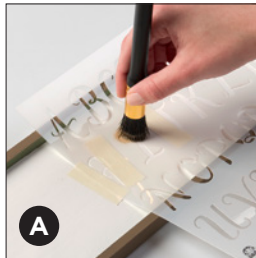

4. Using a 3/4" flat brush, add an accent of Mossy Meadow to the interior rim of the raised frame.
5. Stenciling one letter at a time, stencil the word "BELIEVE" using Ice Coffee. NOTE: A helpful hint when stenciling a word, always begin stenciling the middle letter in the center of the surface. **(Photo A)** Allow a stenciled letter to completely dry before repositioning and stenciling a letter to either the right or left over it. **(Photos B)**
6. Embellish "BELIEVE" with the stenciled scroll leaf design. **(Photo C)** Allow to dry.

Supply List

FolkArt® Acrylic Colors -
Cottage Chic Collection
Iced Coffee, Mossy Meadow

FolkArt Acrylic Colors -
Wicker White

FolkArt Stencil Variety Packs
- Lily & Val - Mixed Fonts

FolkArt 5/8" Stencil Brush

ArtMinds® Wood Plaque -
18" x 5"

Miscellaneous supplies found
on page 3

TRANSFORM YOUR DECOR

COASTAL COLLECTION

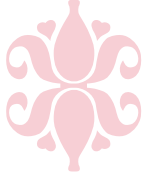

6447
Conch Shell



6452
Fire Coral



6460
Adrift



4621
Minted Aqua



6459
Ocean View



6465
Silver Marlin



6446
Cottage White

Feeling like a forever vacation, this Coastal color palette brings the relaxation of a day at the beach back home with you!

The motivation for this trend color palette is the use of serene, sun bleached hues inspired by seafoam greens, driftwood, seashells, and ocean surf blues.

The Coastal style is very casual yet still remains chic. It uses, maritime and marine life motifs, seamlessly integrated with natural elements to create the look.



COASTAL BEACH SIGN

By Sherrie Ragsdale

Everyone loves time spent at the beach, whether it's a full-time residence or simply a summer vacation! This easy-to-create BEACH sign is a simple way to be artistic, in an afternoon, while incorporating the new FolkArt Acrylic Coastal Color Trend Collection. Even in the dead of winter, you will be reminded of fun, summertime memories at the beach!

INSTRUCTIONS

Refer to Stenciling Basics on page 4 for helpful how-to stenciling hints.

1. Flip wood pallet sign over exposing backside. Using a pair of pliers, remove the staples and twine hanger, then save to use later. Flip pallet sign over and position it so that the wood slats are vertical.
2. Working with the large chalk brush, apply a horizontal Ombre to the pallet sign painting dark at the bottom working towards the lightest color at the top. NOTE: Using five colors to create the Ombre, each color section will measure approximately 1/5 the height of the pallet sign. Begin painting Silver Marlin at the bottom painting upwards approximately 1/5 the height of the sign.



Supply List

FolkArt® Acrylic Colors -
Coastal Collection
Silver Marlin, Adrift, Ocean View,
Marina Mist, Cottage White

FolkArt Acrylic Colors -
Coffee Bean

FolkArt 5/8" Stencil Brush

Artminds® DIY Home - Monogram
Stencils

Artminds DIY Home - Large
Chalk Brush

Artminds Wood Pallet Sign
25" x 14.2" x 1.2"

Miscellaneous supplies found on
page 3

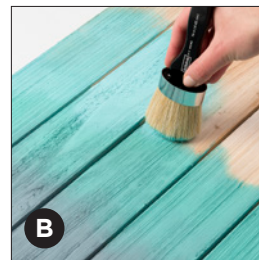
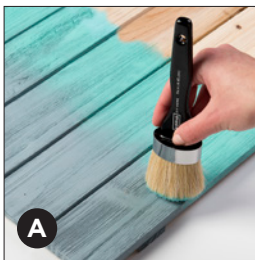

3. While Silver Marlin is still wet, begin painting Adrift as the next color. Allow the two colors to softly blend. **(Photo A)** NOTE: For best results when blending the two colors, use a circular motion.
4. Continue painting each color section of the Ombre while softly blending the transition of colors. The next color is Ocean View. **(Photo B)** Continue with Marina Mist and Cottage White. Allow to dry.
5. On the second vertical wood slat from the left, stencil B E A C H using a 5/8" stencil brush and Coffee Bean. NOTE: When stenciling a word, always begin stenciling the middle letter in the center of the surface. Allow each stenciled letter to completely dry before positioning and stenciling the next letter. Allow to dry. **(Photo C)**
6. Using a staple gun, reattach the twine hanger on the backside of the pallet sign, to hang vertically.

STORAGE CRATES, STARFISH FRAME & SERVING TRAY

By Sherrie Ragsdale

In every home, storage is a **MUST** to keep our possessions organized! Decorate a few crates using the new FolkArt Acrylic Colors from the Coastal Trend Collection combined with a FolkArt compass stencil and you will add just the right finishing touch to a beach-inspired room setting! And for fun, here are a few extra bonus projects: a painted frame with starfish and a beach-inspired planked serving tray!

INSTRUCTIONS

Small Coastal Storage Crate

1. Apply a basecoat of Cottage White to the entire crate using a large basecoating brush and allow to dry. If desired, sand smooth using medium grit sandpaper then reapply basecoat.
2. Next, paint the side wood slats. Paint the top slat Silver Marlin. The middle wood slat is painted Marina Mist. The bottom wood slat is painted Adrift. Allow to dry.
3. To create a coastal worn effect, sand to distress the wood edges using medium grit sandpaper.

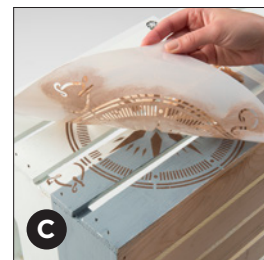
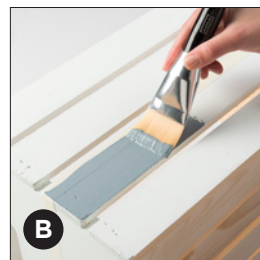
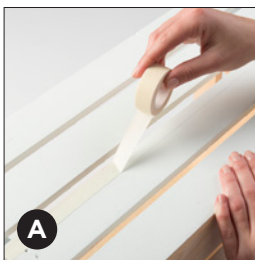

Large Coastal Storage Crate

Refer to Stenciling Basics on Page 4 for helpful how-to stenciling hints.

1. Using a large basecoating brush, paint the entire crate Cottage White. Allow to dry. If desired, sand smooth using medium grit sandpaper and reapply basecoat.
2. Measure vertically and lightly mark with a pencil approximately one-third up from the bottom around the entire crate.
3. Apply stencil tape horizontally just above the penciled mark, press in place. **(Photo A)**
4. Paint Silver Marlin below the tape using the same basecoating brush. Allow to dry and then remove the stencil tape. **(Photo B)**
5. Place the Compass stencil where desired or on the left side of the crate front. Secure stencil in place using stencil tape.
6. Stencil the compass design Coffee Bean; allow to dry. **(Photo C)**
7. Distress the crate edges using medium grit sandpaper.

Starfish Frame

1. Disassemble the shadowbox for painting.
2. Basecoat the interior of the shadow box Silver Marlin using a large basecoating brush. Allow to dry.
3. Paint the frame exterior Marina Mist and let dry.
4. Once dry, use a Mod Melter or a hot glue gun to attach the starfish to the frame interior.

Beach-inspired Serving Tray

1. Using a large basecoating brush, paint the entire tray Cottage White. Allow to dry. Reapply for opaque coverage.
2. Paint the interior of the tray Adrift. Allow to dry.
3. Using medium grit sandpaper, sand to distress the edges creating a coastal worn effect.

Supply List

FolkArt® Acrylic Colors -
Coastal Collection

Cottage White, Silver Marlin,
Marina Mist, Adrift

FolkArt Acrylic Colors -
Coffee Bean

FolkArt Painting Stencil - Large
12" x 12" - Compass

Artminds® Small Wood Crate
with cutout handles

Artminds Large Wood Crate
with cutout handles

Artminds Craft It - Large
Planked Wooden Tray

Studio Décor® - 4-way
Adjustable Shadowbox

Starfish (in variety of sizes)

Miscellaneous supplies found on
page 3

COASTAL STAR STENCILED LAMP SHADE & BUOYS

By Sherrie Ragsdale

Reminiscent of days at the beach, this stenciled lampshade, complete with painted buoys, adds just the right finishing touch to a beach or nautical-themed decor. The pattern of quick-to-stencil stars appear to be starfish dancing. These projects are inspired by the FolkArt Acrylic Coastal Color Trend Collection.

INSTRUCTIONS

Stenciled Lampshade

Refer to Stenciling Basics on page 4 for helpful how-to stenciling hints.

1. Apply stencil adhesive to the backside of Stars Forever stencil; allow to become tacky.
2. Position stencil where desired on the lampshade and press in place.
3. Stencil star pattern onto the white lampshade using Coffee Bean. **(Photo A)** NOTE: Before repositioning stencil to continue star pattern, allow stenciled areas to completely dry.
4. Continue stenciling star pattern until entire lampshade has been stenciled with an overall star design or as desired. **(Photo B)**

Painted Wood Buoys

1. Paint both wooden buoys Cottage White using a large basecoating brush. Allow to dry.



Supply List

FolkArt® Acrylic Colors -
Coastal Collection
Cottage White, Ocean View,
Silver Marlin

FolkArt Acrylic Colors -
Coffee Bean

FolkArt Painting Stencil - Large
12" x 12" - Stars Forever

FolkArt 5/8" Stencil Brush

Lamp with white fabric shade

Wooden buoys - quantity 2

Artminds® DIY Home - Stencil
Adhesive

Miscellaneous supplies found on
page 3, plus jute rope



- If desired, sand smooth using medium grit sandpaper then reapply Cottage White for opaque coverage.
2. Measure approximately 1½"-2" inches up from the bottom and lightly mark with a pencil. Apply stencil tape just above the pencil marking.
3. Paint the base of each buoy just below the tape line. Paint Silver Marlin and Ocean View. Allow to dry, then remove the stencil tape.
4. Using medium grit sandpaper, sand to distress along the edges to expose Cottage White achieving a coastal feel. **(Photo C)**
5. Assemble the lamp, replacing the stenciled lampshade and tying the buoys to jute rope then to the lamp.

TRANSFORM YOUR DECOR

ROMANTIC COLLECTION



6450
Plantation Rose



6455
Wild Wasabi



6458
Marina Mist



6449
Blue Lullaby



6464
Graphite Blue

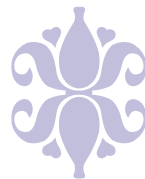

4666
Lilac Ice



6463
Pale Gray

The Romantic Color Trend is an elegant mix of both neutral and pastel tones that are accented with luxurious vintage metals.

This color palette encompasses a rich, full spectrum but is softened with the dusted hues found in a country garden. When you think of heather, antique roses and dusty miller, you envision the colors of this Romantic Color Trend Collection. These colors are feminine and fresh.

Classic adornments and embellishments of the Romantic Trend combine both floral and architectural details.



ROMANTIC HAND PAINTED CANDLESTICKS

By Suzanne Cook

Designed to accent any decor, these sweet, romantically-inspired hand painted candlesticks are both easy and fun to create! With two colors from the FolkArt Acrylic Romantic Color Trend Collection, a couple small, detail paintbrushes and a few hours of time, these gorgeous wood turned candlesticks can be created in an afternoon!

INSTRUCTIONS

1. Prepare the candlesticks by sanding smooth any rough areas using medium grit sandpaper. Wipe clean to remove sanding dust.
2. Paint each candlestick Pale Gray and allow to dry. If desired, sand smooth then reapply a second coat of Pale Gray. Allow to dry. **(Photo A)**
3. Using the project photo as inspiration, paint Cottage White simple lines, daisy flowers and leaves on each segment of the turned wood candlesticks.
4. **Painted Teardrops** - Select a segment and paint a horizontal row of teardrops. To paint a teardrop, load a No. 2 round brush with Cottage White. With light pressure on the brush, touch the top edge of the segment and begin to pull the brush downwards applying pressure which will create a wider bottom of the stroke, resembling a teardrop. **(Photo B)**

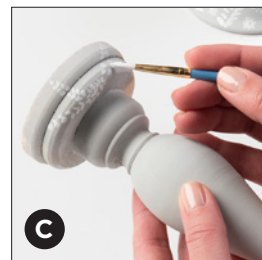
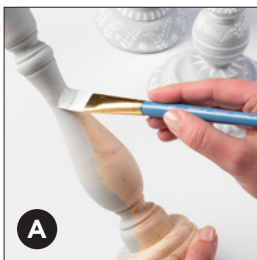

5. **Painted Leafy Fern** - Load a No. 2 round brush with Cottage White. Begin at the base of the arching fern and paint a small petal or comma stroke. Paint a second stroke beside the first one creating the illusion of a painted "v" without touching at the base. Add a pair of brush strokes above the first pair, only smaller. **(Photo C)** Continue adding smaller pairs of strokes in an arching design until the last fern leaf is painted at the tip. NOTE: This design intentionally does not have a center stem, however, one can be added as shown on the tall candlestick.
6. **Painted Flowers** - Small daisy-like flowers are easily painted using the No. 2 round brush loaded with Cottage White. Begin painting a small circle for the flower center. Next, add small petal or comma strokes of varying sizes around the flower center.
7. **Painted Line Work** - Embellish between the painted daisy flowers and vines by adding a painted horizontal band around the candlestick. Begin by thinning Cottage White with water so the paint will flow from the brush easily. Load a liner brush with the thinned Cottage White and add the painted line work where desired.

Supply List

FolkArt® Acrylic Colors -
Romantic Collection
Cottage White, Pale Gray

Ashland® Wood Pedestal
Candlestick

Artminds® Wood Pedestal

Artminds Wood Decorative
Candlestick - 6³/₄"

Craft Smart® Round/Detail
Brush Set

Miscellaneous supplies found on
page 3

ROMANTIC FRENCH TAPESTRY

By Suzanne Cook

This French-inspired painted tapestry provides a warm, vintage feel to a gallery wall or hung to be admired by itself! Using a few paints from the FolkArt Acrylic Romantic Color Trend Collection, a large FolkArt stencil and a few brushes, this dreamy tapestry can be created for your home too!

INSTRUCTIONS

Refer to Stenciling Basics on page 4 for helpful how-to stenciling hints.

Canvas Preparation

Begin by tearing the canvas fabric to create a 24" square. To do so, measure, then cut a small slit into the canvas at the top and again at the 24" mark at the bottom; then pull to tear the canvas leaving an unfinished edge. Remove all loose strings; iron smooth.

1. Position the canvas fabric on a large flat surface and then secure in place using stencil tape. Pour a generous amount of Cottage White onto a palette.
2. Create a vintage distressed background by loading a distressing block with Cottage White by dipping the flat surface of the tool into the

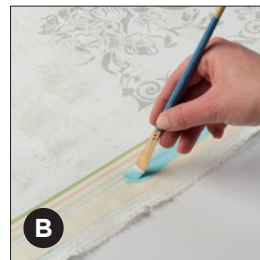

puddle of paint. Press the tool to the canvas and drag across the surface creating a "hit and miss" effect with the paint application. Continue creating this effect over the entire tapestry surface. Allow to dry. **(Photo A)**

3. Paint the tiny 1/4" horizontal bands of color at the top and bottom of the tapestry. NOTE: It is best to use stencil tape to design the horizontal lines before applying paint. Once taped, paint two Blue Lullaby lines at the top and bottom. Allow to dry and remove the tape. **(Photo B)**
4. Continue taping to create a 1/4" stripe of Plantation Rose at the top of the tapestry just below the pair of Blue Lullaby stripes; let dry and remove tape.
5. The last horizontal painted stripe is Wild Wasabi painted just below the Plantation Rose stripe. Let dry.

Stenciling

The large stencil design, Fleurs, is created from a four part layered 12" x 12" stencil. Simply begin with one part and stencil a quarter of the design. Continue with each of the three remaining sections to complete the entire Fleures stencil design. Stencil using Pale Gray. **(Photo C)**

Finishing

Hammer a small picture hanger bracket to the center of a 24" long flat strip of molding. Glue the molding to the back of the tapestry along the top edge. NOTE: Apply pressure or weight to the molding while the glue is drying.

Supply List

FolkArt® Acrylic Colors -
Romantic Collection
Cottage White, Blue Lullaby,
Plantation Rose, Wild Wasabi,
Pale Gray

FolkArt Painting Stencil -
12" x 12" - Fleurs

Crafty Cuts® Canvas Cloth -
white (slightly larger than 24"
square)

ArtMinds® DIY Home
Distressing Block

Miscellaneous supplies found
on page 3 plus, an iron, picture
hanger bracket, 24" strip of flat
molding, glue, and scissors

ROMANCE-INSPIRED HAND PAINTED BOXES

By Suzanne Cook

The romantic beauty of these stacking boxes is that they are hand painted purposefully not perfect. Stripes are hand painted and the width of a paintbrush, liner brush stripes are freehand without taping guidelines, base colors are dry brushed lightly exposing the natural papier mache background. These boxes, inspired by the FolkArt Acrylic Romantic Color Trend Collection, are not only beautiful, they are also easy-to-create!

Supply List

FolkArt® Acrylic Colors -
Romantic Collection
Blue Lullaby, Plantation Rose,
Wild Wasabi, Pale Gray

FolkArt Acrylic Colors -
Vintage White, Daffodil Yellow,
Real Brown

Artminds® Papier Mache
Square Box - 7.5"

Artminds Papier Mache
Square Box Set - Medium
Box 5"

Artminds Papier Mache
Round Box - 4"

Artminds Papier Mache Mini
Round Box - 2.75"

Craft Smart® Round/Detail
Brush Set

Miscellaneous supplies found
on page 3, plus small piece of
scrap wood, and small piece
of cloth



INSTRUCTIONS

Papier Mache Box Preparation

Dry brush a light application of Vintage White on the exterior of all boxes and lids. NOTE: Dry brushing simply means to lightly load your paintbrush with paint and then apply, with little pressure, quick, airy strokes achieving a somewhat "hit or miss" effect allowing some of the natural surface to show.



(Continued on next page)

ROMANCE-INSPIRED HAND PAINTED BOXES

By Suzanne Cook

Blue Lullaby Small Round Box

1. Paint the box lid Blue Lullaby using a 1/2" flat brush and the dry brush paint technique; allow to dry.
2. Using the same brush, color, and technique, paint evenly 1/2" stripes around the box. Let dry.
3. Paint a Daffodil Yellow vertical stripe in the center of the Vintage White stripe using a liner brush. Add a circle of Daffodil Yellow tiny hearts on the box lid. Allow to dry.

Plantation Rose Round Box

1. Paint the box lid Plantation Rose using a 1" flat brush and the dry brush paint technique; allow to dry.
2. Using a liner brush, paint a pair of vertical stripes evenly spaced around the box. NOTE: Each pair of stripes are approximately one inch apart. **(Photo A)**
3. Next, paint a vertical row of Daffodil Yellow small hearts on the Vintage White stripe. Let dry. **(Photo B)**

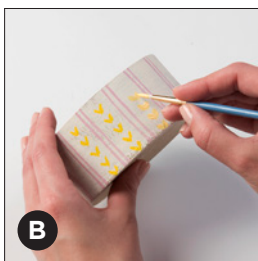
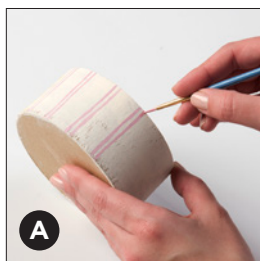

Wild Wasabi Square Box

1. Paint the box lid Wild Wasabi using a 1" flat brush and the dry brush technique.
2. Using a liner brush, paint a Blue Lullaby line border on the lid approximately 1/2" in from the edge. Still using the liner brush and Blue Lullaby, paint a vertical stripe on the edges of the Wild Wasabi vertical stripes. Also add a painted Blue Lullaby vertical stripe in the center of the Wild Wasabi stripe.
3. Paint pairs of Blue Lullaby leaves along the line work on the lid. Using the liner brush, paint a pair of petal or comma strokes similar to a "v" creating the illusion of a leafy vine. Continue painting the same leafy vine in the center of each Wild Wasabi painted stripe.

Pale Gray Large Square Box

1. Using a ruler and pencil, measure and lightly mark a rectangle on each box side and a 6 1/2" square on the lid. Create a mask by taping around each shape. Paint inside each taped rectangle Pale Gray. Paint the lid edge Pale Gray. Also paint the 1" border around the square on top Pale Gray using the dry brush technique. Let dry. Remove stencil tape carefully.
2. Using a liner brush and Blue Lullaby, paint a freehand line around the lid's white square. Add a painted detail of three stroke leaf shapes in each corner.
3. Repeat the same line work and leaf detail on the box sides outlining the Pale Gray rectangles. Add a freehand rectangle just inside the Pale Gray painted rectangle shape accented with a three leaf detail design in the center.

Finishing Details for All Painted Boxes

Paint a vintage, distressed effect to embellish each box. Dip a small piece of scrap wood into Real Brown, then lightly scrape over the box surface applying Real Brown in a very scattered fashion. Dampen a small cloth and lightly wipe over the almost dried paint which will remove excess Real Brown and randomly create a wash of brown over other areas adding to the aged and distressed finish. Allow to completely dry.

ABOUT THE DESIGNERS

SUZANNE COOK has been an artist and crafter since she was a child. She received her BFA from the University of Georgia in graphic design. Suzanne's creative roles have included designer, art director, middle school teacher, theater costume and set designer, and painter. A Georgia native, she lives in Suwanee with her husband Dave and their little three-legged dog, Rosie. Suzanne loves her current role as one of Plaid's Inspiration Designers where she can draw on all of her many artistic skills every day. She says, "I have the ultimate dream job!"

KIRSTEN JONES has been crafting for the past 25 years. She specializes in whimsical and folksy paintings. For inspiration, she attends and exhibits at art shows across the country. She's had her work published in numerous craft books and has appeared on multiple DIY and home shopping shows, including QVC.

SHERRIE RAGSDALE is a creative person whose life experiences help her grow and continually add unique skills to her rewarding job as a freelance designer at Plaid Enterprises. Sherrie's amazing two boys inspire and challenge her on a daily basis to approach life with a renewed creative spirit. The combination of Sherrie's passions, thrifting and building, results in a special ability to combine everyday objects into pieces of art.

CREATIVE CREDITS Plaid Enterprises Production Team: Category Director, Carl Reichenbach; Brand Manager, Andy Jones; Art Director, Paul LaPlaca; Graphic Designer, Jennifer Byerley; Design Director, Jackie Wynia; Hand Model, Anna Teal; Photography, Bill Skeel / John Armitage; and Education Content Curator, Chris Williams.

COLOR TREND COLLECTIONS



COTTAGE CHIC



COASTAL



ROMANTIC